



TIMBER

MAINTENANCE

ARCHITECTURAL HARDWOOD DECKING, CLADDING & CEILING SYSTEMS



1800 894 400
info@mortlock.com.au
www.mortlock.com.au



EXTERIOR TIMBER MAINTENANCE

CUTEK OIL

This is the standard coating supplied unless others are requested. Clear Cutek CD50 is a penetrating oil which is designed for external use and can also be used for internal applications.

To maintain the natural timber colour with Cutek CD50

One coat of Cutek CD50 Clear should be applied to all surfaces of the timber prior to delivery by Mortlock Timber Group. A second coat of Cutek CD50 with Colourtone should be applied once installation is complete. Any second coat should only be applied once the first coat has completely penetrated and is dry. The time taken for Cutek CD50 to diffuse into the timber varies significantly, depending on aspect, species, ambient temperature, porosity, and moisture content of the timber.

A Colourtone must be added to delay the silvering process and enhance the natural character and colour of the timber. Colourtone Cutek oils can still look like a clear finish, depending on the Colourtone selected. <http://cutek.com.au/products-colourtones.html>

A third coat of Cutek CD50 with Colourtone should be applied once construction is complete. A fourth coat should be applied within 6 months of third coat and timber should be recoated every 12-18 months thereafter to maintain natural timber colour. Should timber show any signs of weathering or drying, oil should be applied.

To allow timber to weather and maintain weathered finish

One coat of Cutek CD50 Clear should be applied to all surfaces of the timber prior to delivery by Mortlock Timber Group. A second coat of Cutek CD50 Clear should be applied once installation is complete. Any second coat should only be applied once the first coat has completely penetrated and is dry. The time taken for Cutek CD50 to diffuse into the timber varies significantly, depending on aspect, species, ambient temperature, porosity, and moisture content of the timber.

Timber that is coated with a Cutek CD50 Clear wood protection oil will gradually silver (see image below) over time on exposure to sunlight, while remaining dimensionally stable.

A third coat of Cutek CD50 Clear should be applied once construction is complete. A fourth coat should be applied within 6 months of third coat. Maintenance coats can be applied as often as every 12-18 months to reduce minor surface checking and maintain stability. Typically, weathered surfaces can be left up to 4-5 years without recoating.

To restore timber to new look after it has silvered see:

<http://cutek.com.au/factsheets/FS%20No6%20Proclean.pdf>

Further information on Cutek Timber Oil see:

<https://www.cutek.com.au/>





INTERNAL TIMBER MAINTENANCE

Regardless of the coating used, Interior timber typically does not normally need maintenance. It is important to regularly check timber exposed to UV radiation through windows etc, as this can lead to yellowing of the coating. Re-coating and touch ups may be required.

Timber can be cleaned with a soft bristled broom and a damp cloth. Where cleaning products are required, please follow manufactures instructions and test small area before using to make sure it will not damage the timber or timber coating.

General wear on internal timber can be touched up with the same coating used originally when required.

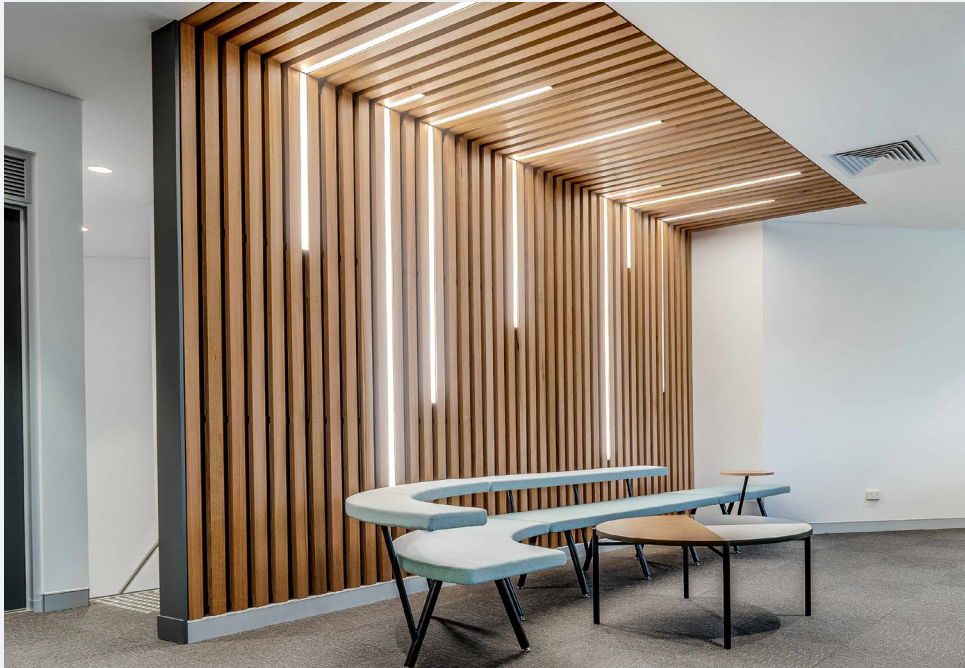

FINISH OPTIONS

UNFINISHED TIMBER

Unfinished timber is available where required. This is mainly used where our factory applied finish options do not meet the specifications required or where no timber finish is required. Unfinished timber is not recommended for external or high humidity applications.

CUTEK OIL

This is the standard coating supplied unless others are requested. Cutek Oil is an oil-based coating that works by penetrating the surface of the timber. When exposed to the weather regular maintenance is required.

COST: \$ - Low

USE: Interior & Exterior Applications

ENVIRO CLEAR

Enviro Clear is a water based LVOC product for interior use only. It is a film forming, non-yellowing coating which is easy to clean and requires minimal maintenance. Timber is sanded, and factory coated prior delivery with Enviro Clear providing a premium furniture grade finish for interiors. Minimum order quantity applies.

COST: \$\$ - Medium

USE: Interior Applications Only

FIRESHIELD TIMBERCLEAR 1FR

Fireshield TIMBERCLEAR 1FR is a clear timber intumescent coating that is used to achieve a Group 1 and 2 fire rating to internal timber surfaces. Minimum order quantity applies.

COST: \$\$\$ - High

USE: Interior Applications Only

To view images of timber species with the above finishes applied , visit our product pages on our website.

DESIGN & INSTALLATION CONSULTING

Our team can work through detailing and specification requirements to meet specific project requirements. We can assist with budget management without compromising aesthetics and ensure our products perform with an extended life cycle.

SAMPLES

Mortlock Timber Group samples department is stocked with our full range. We use express delivery service and generally deliver samples to your door within 2-3 days. Custom samples and sample boards can take 3-6 weeks depending on requirements.



MORTLOCK
T I M B E R

W: www.mortlock.com.au

T: 1800 894 400

E: info@mortlock.com.au

Distribution: WA | SA | VIC | NSW | QLD | TAS